



the valve specialists

## A-590 TLD

### One piece reduced bore ball valve



One piece reduced bore ball valve, screwed ends, PN63, PSI1000.

Pipe thread in accordance with ANSI B2.1, BS 21-1973, DIN 259/2999, ISO 128

Size	D (mm)	L (mm)	L1 (mm)	H (mm)	W (mm)	S (mm)
1/4"	5	39	19	30	70	17
3/8"	6.8	44	21	34	90	21
1/2"	9.2	56.5	27.5	41	100	25
3/4"	12.5	59	29	44	100	32
1"	15	71	34.5	50	110	38
1.1/4"	20	78	37	55	110	48
1.1/2"	25	83	40	64	135	53
2"	32	100	49	70	145	65
2.5"	38	128	60	83	190	85
3"	65	153	72	77	189	96

#### Key Features

- Blow-out proof stem/ reduced bore
- Investment casting body and inscrewed
- Option: Locking device, oval or wing handle

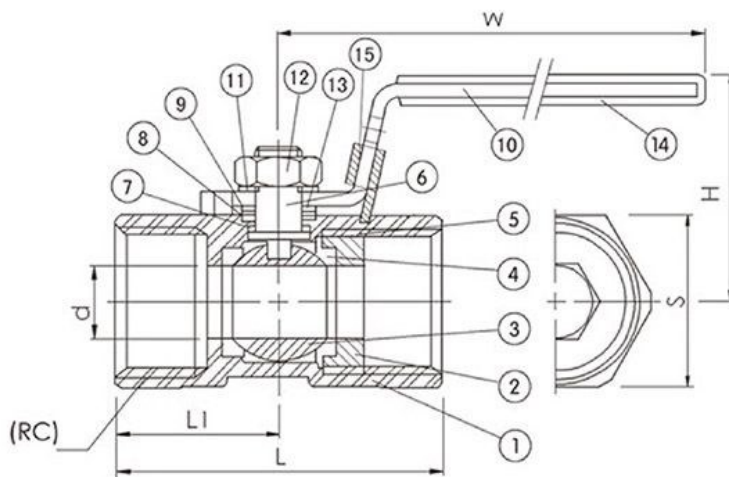

No.	Description	Material
1	Body	ASTM-A351-CF8M
2	Insert	ASTM-A351-CF8M
3	Ball	ASTM-A351-CF8M
4	Ball Seat	PTFE
5	Joint Gasket	PTFE
6	Stem	AISI 316
7	Thrust Washer	PTFE
8	Stem Packing	PTFE
9	Stem Washer	AISI 304
10	Handle	AISI 304
11	Spring Washer	AISI 304
12	Stem Nut	AISI 304
13	Belleville Washer	AISI 304
14	Plastic Cover	Plastic
15	Lock Device	AISI 304

Orseal Ltd, Lynstock Way, Lostock, Bolton, BL6 4QR

T: +44 (0)1204474300 / F: +44 (0)1204474347

E: sales@orseal.com

W: www.orseal.com